

## KOINE 6 - KWXXXXXX

Ceiling mounted luminaires  
design Roberto Mantovani

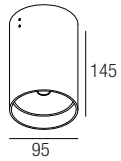

I ISTRUZIONI PER LE AUTORITÀ PREPOSTE ALLA SORVEGLIANZA DEL MERCATO SULLA RIMOZIONE DELLE UNITÀ DI ALIMENTAZIONE SEPARATA  
GB INFORMATION FOR MARKET SURVEILLANCE AUTHORITIES ON REMOVAL OF SEPARATE CONTROL GEAR

I **NOTA** - SOLO VERSIONE AC  
GB **NOTE** - AC VERSION ONLY

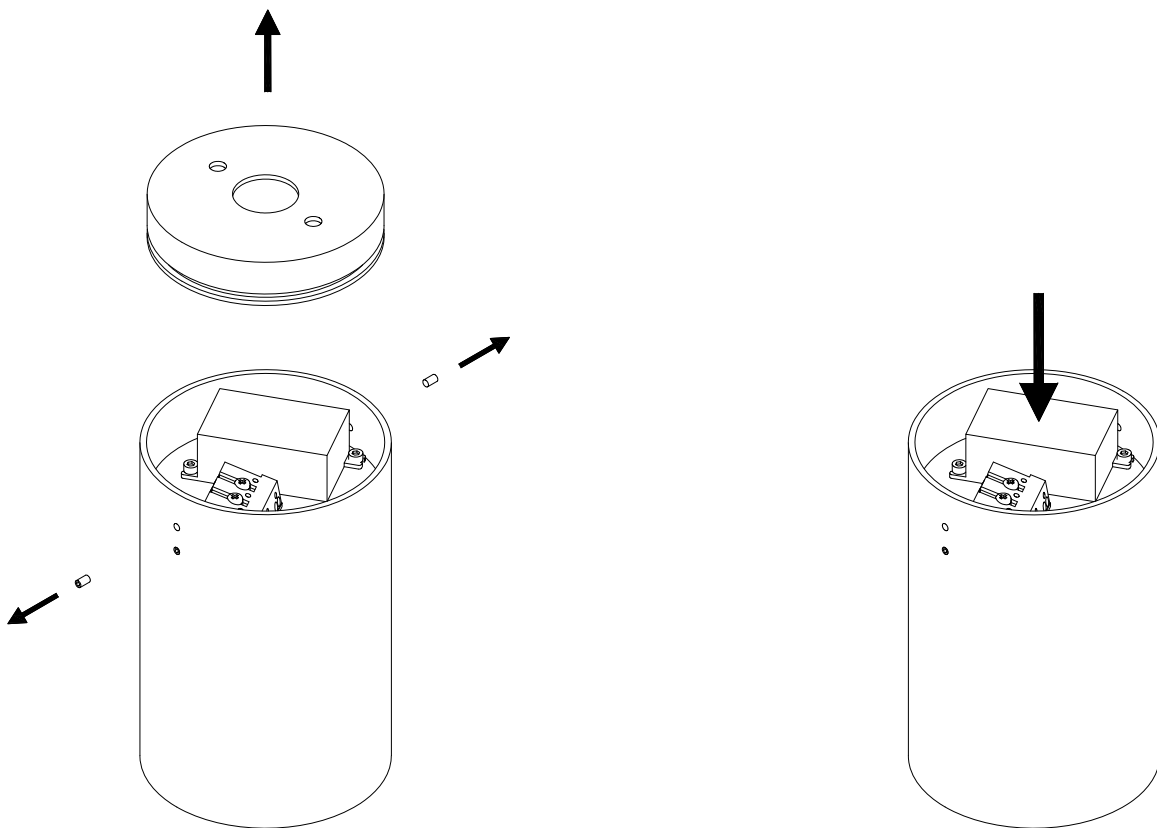

1

I Svitare i grani superiori e rimuovere l'anello.  
GB Unscrew the upper screws and remove the ring.

2

I Unità di alimentazione ispezionabile.  
GB Examinable control gear.

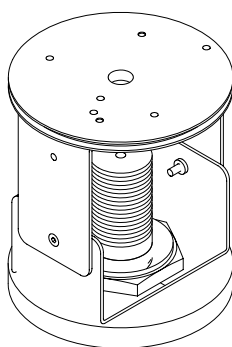
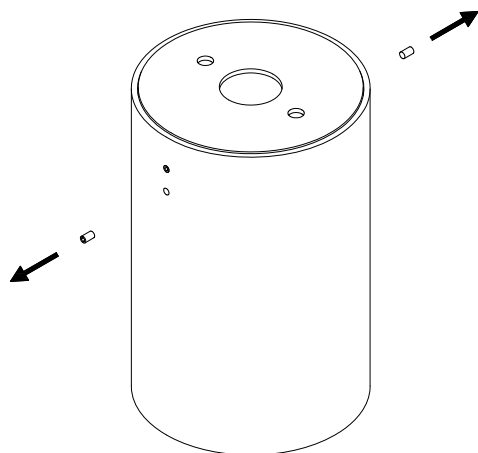

**1**

I Svitare i grani inferiori e rimuovere i componenti interni.  
GB Unscrew the bottom screws and remove the inner components.

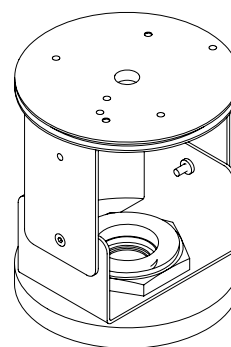
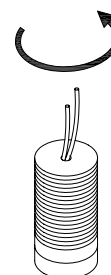

**2**

I Svitare l'apparecchio luminoso per rimuoverlo.  
GB Unscrew the lighting fixture to remove it.

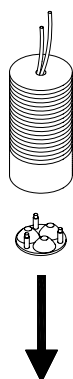

**3**

I Rimuovere l'ottica.  
GB Remove the optic.

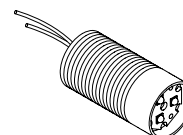

**4**

I Sorgente luminosa ispezionabile.  
GB Examinable light source.