

JOS PS10 - JSPS1XXXX

Pendants

design Roberto Mantovani

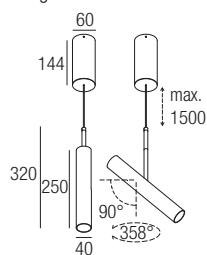

I ISTRUZIONI PER LE AUTORITÀ PREPOSTE ALLA SORVEGLIANZA DEL MERCATO SULLA RIMOZIONE DELLA SORGENTE LUMINOSA E DELLE UNITÀ DI ALIMENTAZIONE SEPARATA
GB INFORMATION FOR MARKET SURVEILLANCE AUTHORITIES ON REMOVAL OF LIGHT SOURCE AND SEPARATE CONTROL GEAR

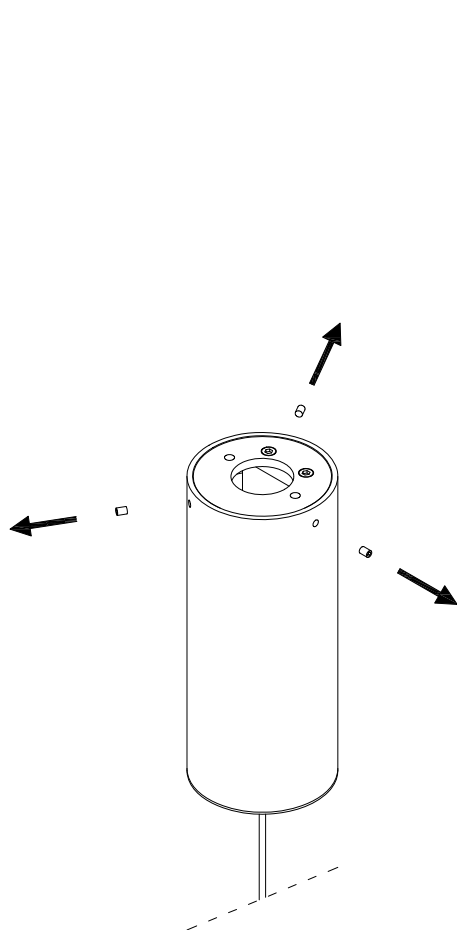

1

I Svitare i grani.
GB Unscrew the screws.

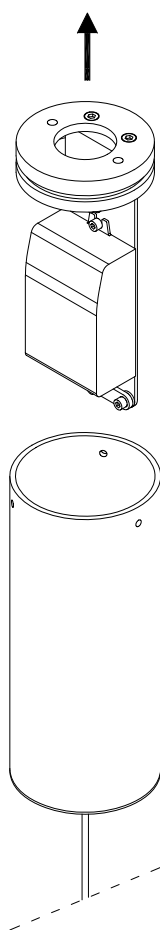

2

I Rimuovere i componenti interni.
GB Remove the inner components.

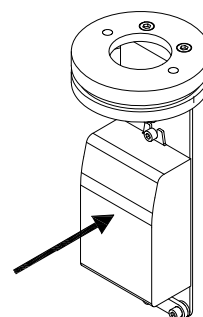

3

I Driver ispezionabile.
GB Examined driver.

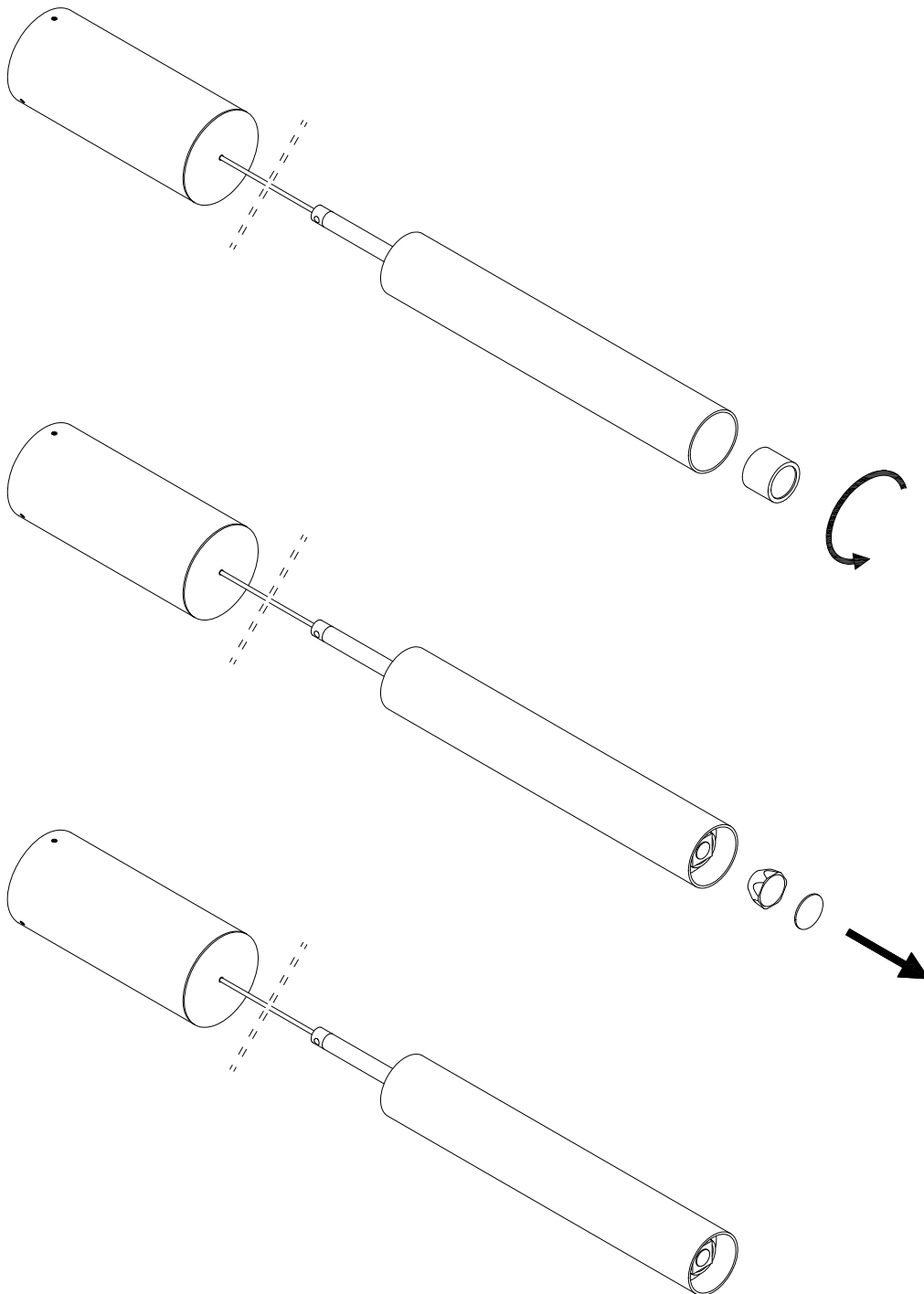

1

I Svitare l'anello frontale.
GB Unscrew the front ring.

2

I Rimuovere l'ottica.
GB Remove the optic.

3

I Sorgente luminosa ispezionabile.
GB Examinable light source.