

## BULL 10 - BU1XXXXX

Projector for 230VAC track

design Lapo Grassellini

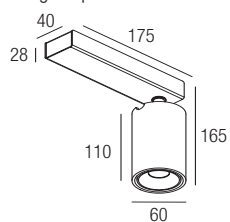

I INFORMAZIONI SULLA RIMOZIONE DELLE UNITÀ DI ALIMENTAZIONE SEPARATA DAL PRODOTTO CONTENITORE A FINE VITA

GB INFORMATION ON REMOVAL OF SEPARATE CONTROL GEAR FROM CONTAINING PRODUCT AT END OF LIFE

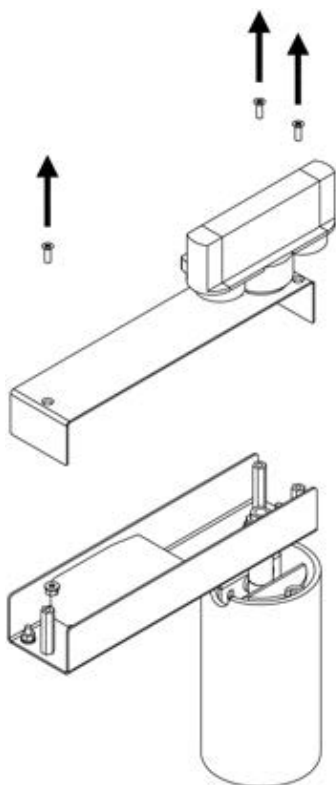

**1**

I Svitare le viti e rimuovere la lamiera superiore.  
GB Unscrew the screw and remove the sheet metal on the top.

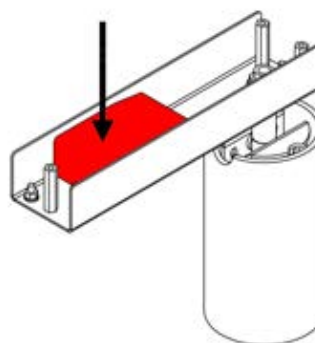

**2**

I Rimuovere l'unità di alimentazione.  
GB Remove control gear.

I INFORMAZIONI SULLA RIMOZIONE DELLA SORGENTE LUMINOSA DAL PRODOTTO CONTENITORE A FINE VITA

GB INFORMATION ON REMOVAL OF LIGHT SOURCE FROM CONTAINING PRODUCT AT END OF LIFE

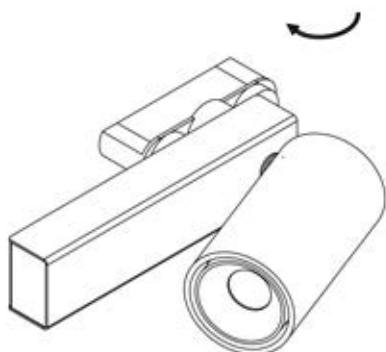

1

I Ruotare il corpo orientabile.  
GB Rotate the adjustable body.

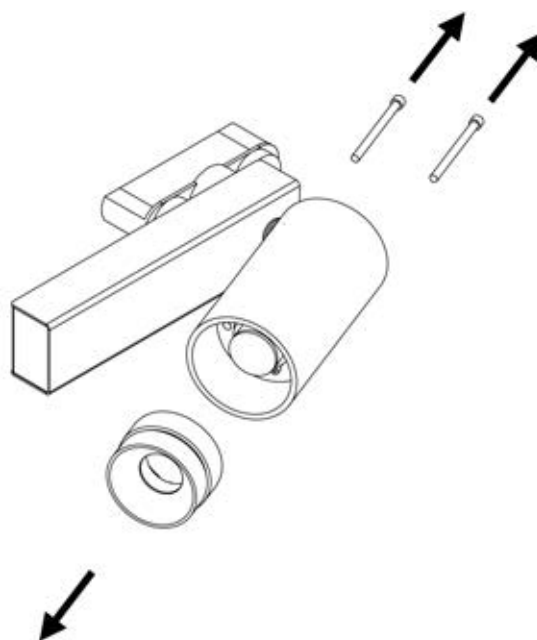

2

I Svitare le viti sul retro e rimuovere l'anello frontale.  
GB Unscrew the screws on the back and remove the front ring.

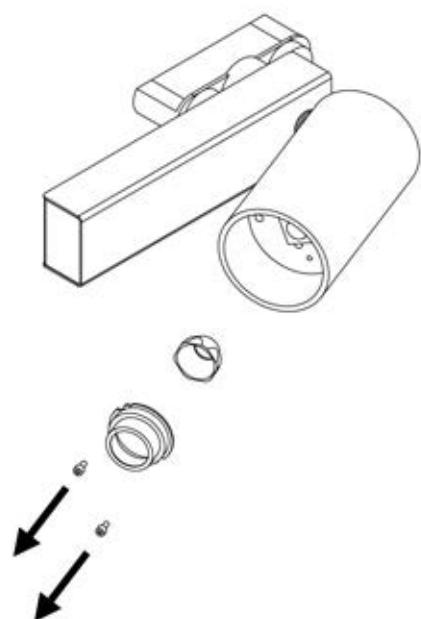

3

I Svitare le viti e rimuovere l'ottica.  
GB Unscrew the screws and remove the optic.

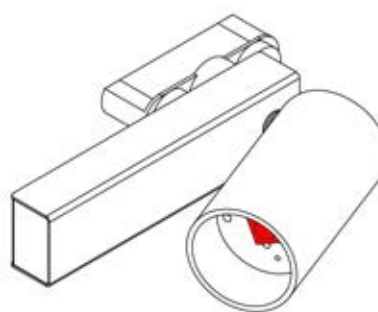

4

I Rimuovere la sorgente luminosa.  
GB Remove light source.