

ARIK 10 - AHXXXX

Ceiling mounted luminaires

design Roberto Mantovani

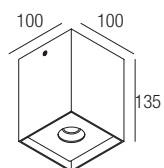

I ISTRUZIONI PER LE AUTORITÀ PREPOSTE ALLA SORVEGLIANZA DEL MERCATO SULLA RIMOZIONE DELLE UNITÀ DI ALIMENTAZIONE SEPARATA

GB INFORMATION FOR MARKET SURVEILLANCE AUTHORITIES ON REMOVAL OF SEPARATE CONTROL GEAR

I **NOTA** - SOLO VERSIONE AC

GB **NOTE** - AC VERSION ONLY

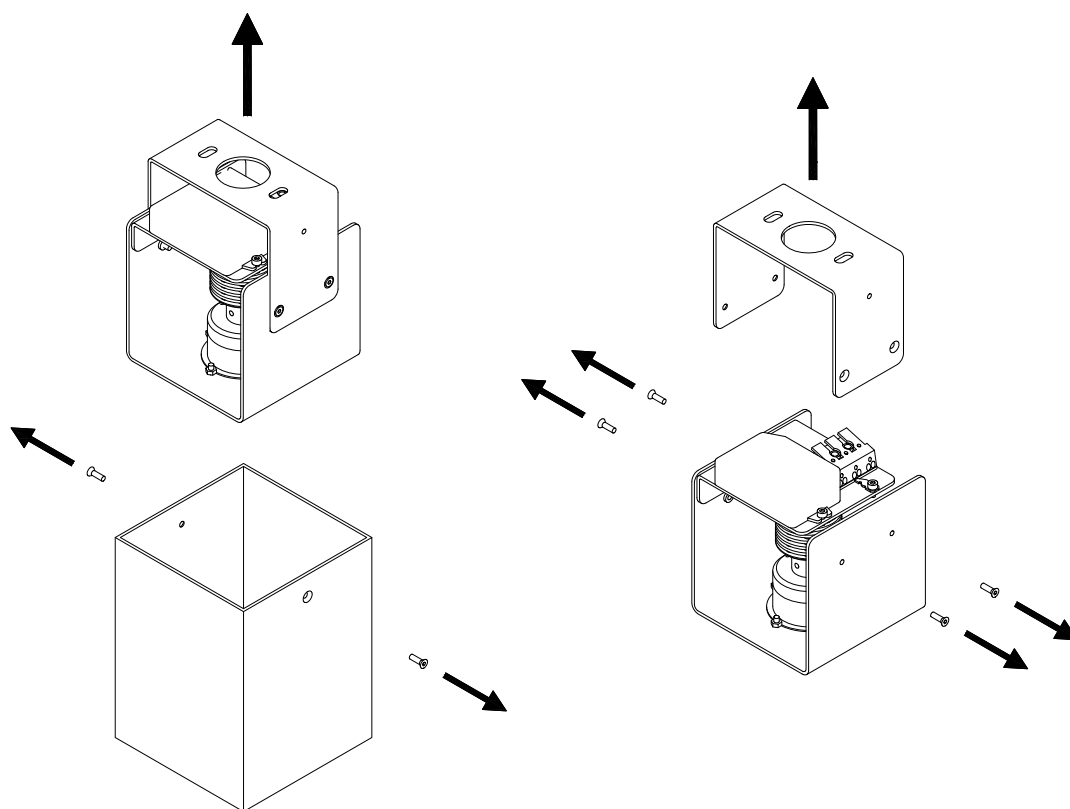

1

I Svitare le viti e rimuovere i componenti interni.
GB Unscrew the screws and remove the inner components.

2

I Svitare le viti e rimuovere la lamiera superiore.
GB Unscrew the screws and remove the metal sheet on the top.

3

I Driver ispezionabile.
GB Examinable driver.

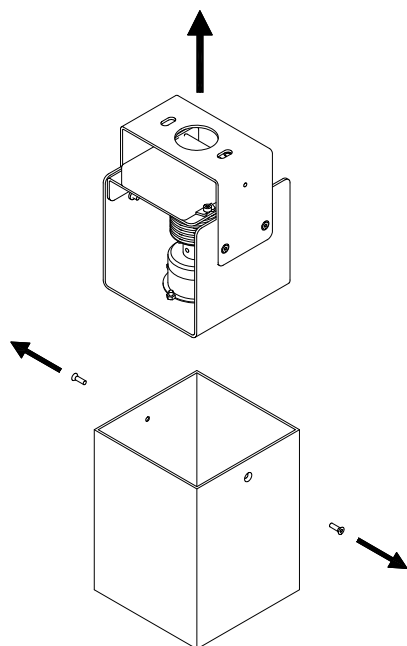

1

- I Svitare le viti e rimuovere i componenti interni.
GB Unscrew the screws and remove the inner components.

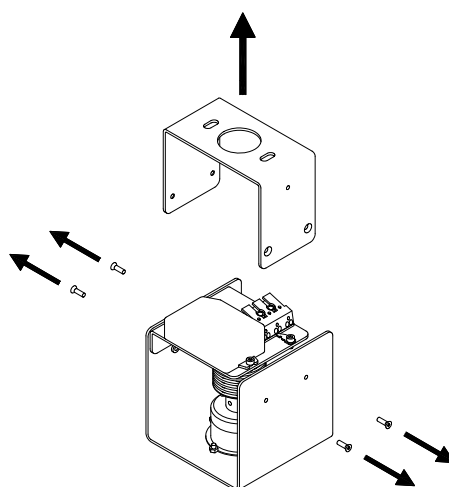

2

- I Svitare le viti per rimuovere la lamiera superiore.
GB Unscrew the screws to remove the sheet metal on the top.

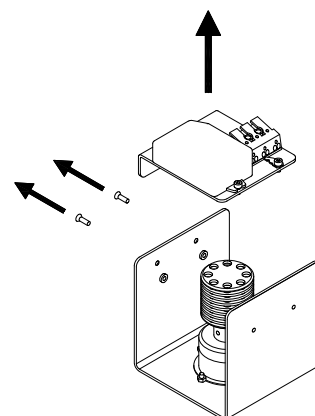

3

- I Svitare le viti per rimuovere la lamiera con il driver.
(solo versione AC)
GB Unscrew the screws to remove the sheet metal with the driver. (AC version only)

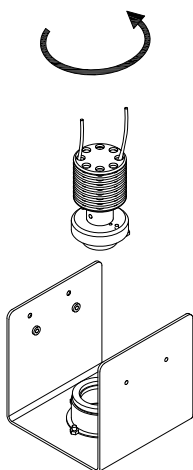

4

- I Svitare l'apparecchio luminoso per rimuoverlo.
GB Unscrew the lighting fixture to remove it.

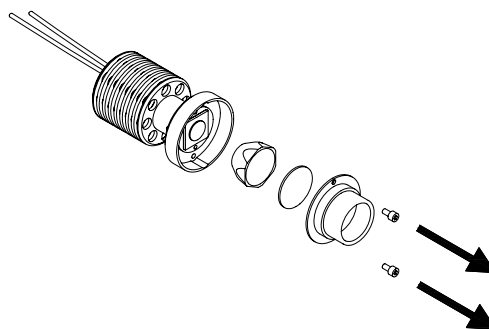

5

- I Rimuovere l'ottica.
GB Remove the optic.

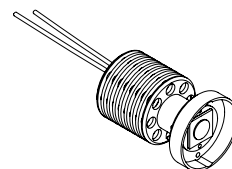

6

- I Unità di alimentazione ispezionabile.
GB Examinable control gear.