

## ALPHA 10 - AP2XXXX1

IP rated downlights  
design Roberto Mantovani

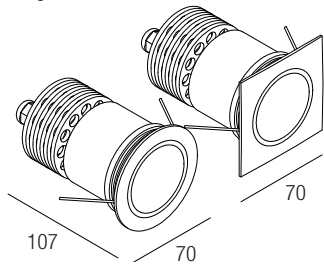

I ISTRUZIONI PER LE AUTORITÀ PREPOSTE ALLA SORVEGLIANZA DEL MERCATO SULLA RIMOZIONE DELLA SORGENTE LUMINOSA E DELLE UNITÀ DI ALIMENTAZIONE SEPARATA  
GB INFORMATION FOR MARKET SURVEILLANCE AUTHORITIES ON REMOVAL OF LIGHT SOURCE AND SEPARATE CONTROL GEAR

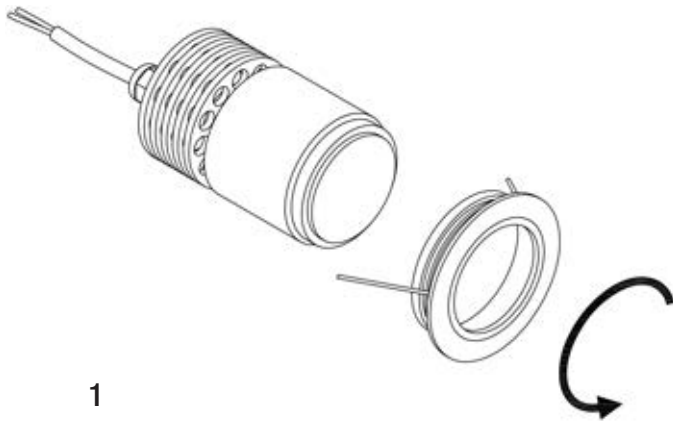

**1**  
I Svitare la parte frontale.  
GB Unscrew the front part.

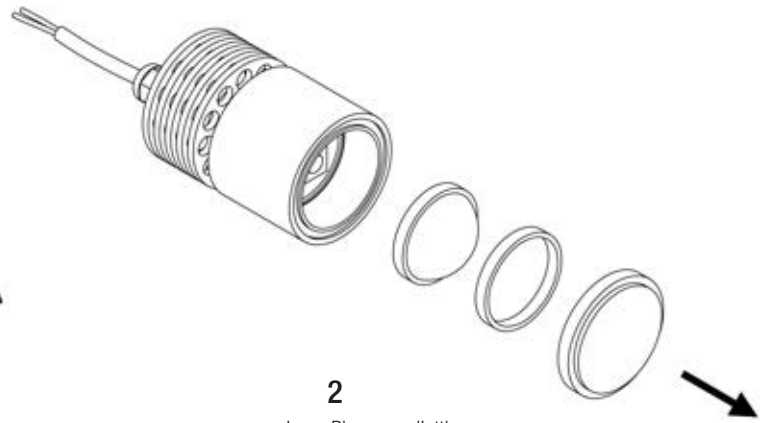

**2**  
I Rimuovere l'ottica.  
GB Remove the optic.

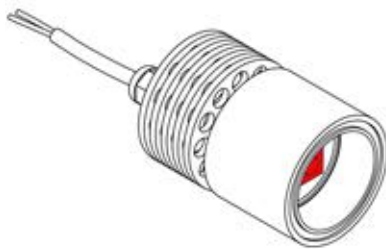

**3**  
I Rimuovere la sorgente luminosa.  
GB Remove light source.